

1	Type	Machine vision Lens			
2	EFL	16mm			
3	F.NO	F2.8~16			
4	Resolution	20MP			
5	Image Format	1.1"			
6	BFL (M)	17.53			
7	For Sensor	1.1"	1"	2/3"	
8	F.O.V	Horizontal	47.8°	43.6°	30.8°
9		Vertical	36°	33.4°	23.3°
10		Diagonal	55.4°	53.1°	37.9°
11	TV Distortion	<0.6%	<0.5%	<0.3%	
12	M.O.D	0.1m			
13	Mount Type	C/CS			
14	Dimension Figure	φ38.00*L82.00			
15	Filter Size	---			
16	Weight	---			

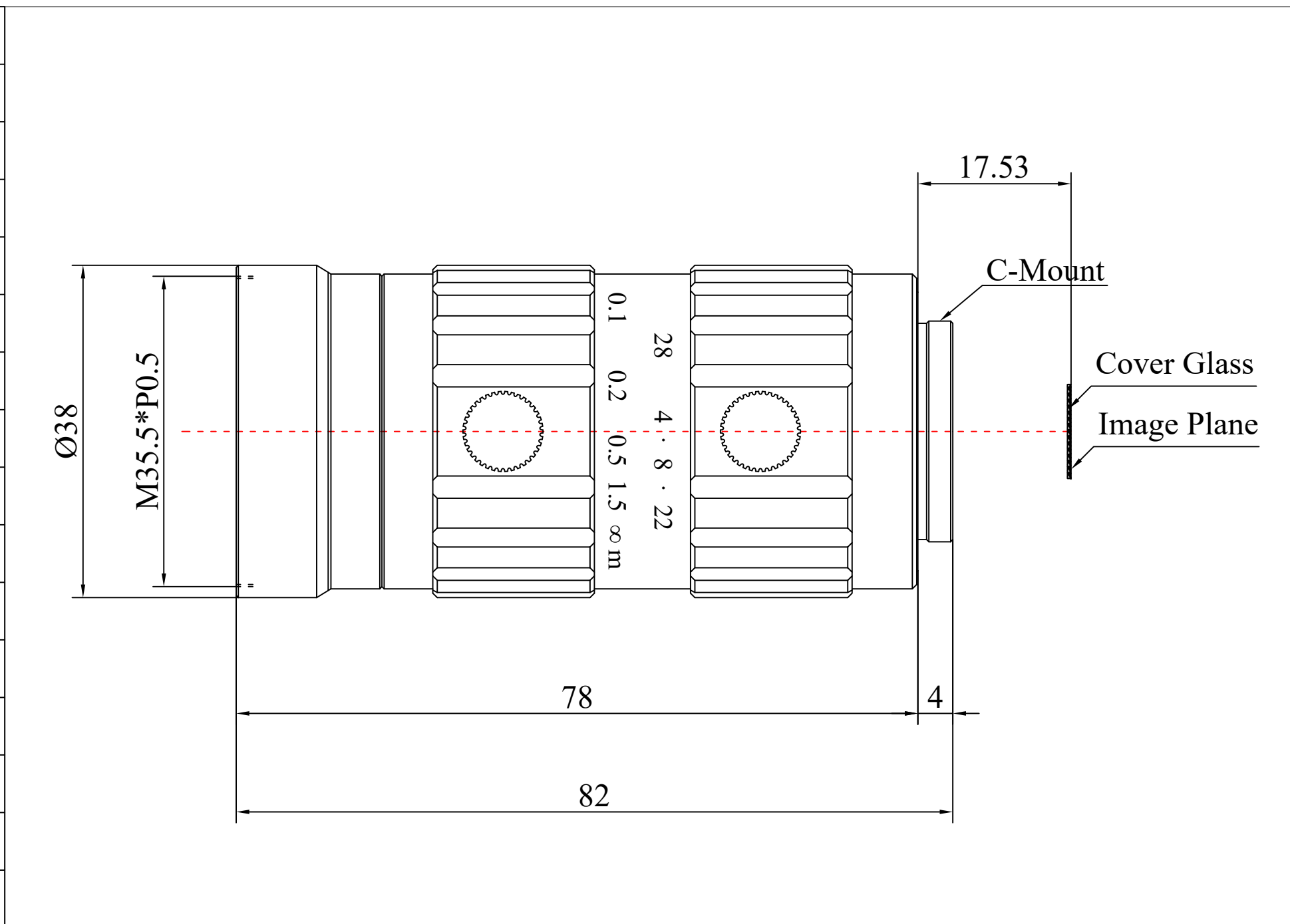

17	Iris Operation	Manual
18	Zoom Operation	Fixed
19	Focus Operation	Manual
20	Operating Temperature	-20° +85°
21	Storage Temperature	-20° +85°

Scale	Remark	Tolerances	Date	Revised	
1.5 : 1	X	±0.2	2021-01-15	CH603A Rev1.0	
	X.0	±0.15			
Units	X.00	±0.10	Design	Linda	2016-02-10
	X.000	±0.001	Checked	Anna	2016-05-07
mm	Angle	±0.5°	Approval	Sanmu	2016-05-28

福州创安光电科技有限公司  
FUZHOU CHUANGAN OPTICS CO., LTD

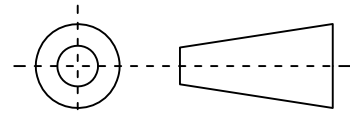

3D Angle Projection