

1	Type	Low Distortion Lens	
2	Resolution	10MP	
3	Image Format	1/1.8"	
4	Image Circle	φ9.0mm(MAX)	
5	EFL	4.5mm	
6	TTL	30.00mm	
7	F/NO.	2.0	
8	FFL (M)	5.16mm	
9	BFL (O)	5.90mm	
10	For Sensor	IMX334	
11	F.O.V	Horizontal	90°
12		Vertical	54.8°
13		Diagonal	99°
14	OPT Distortion	<-14.2%	
15	Relative Ill.	>63%	
16	Chief Ray Angle	<10.4°	
17	M.O.D	0.1m~∞	
18	Mount Type	M12*P0.5	
19	Dimension Figure	φ24.00*L24.84mm	
20	Lens Structure	12G	
21	IR-Filter	T=50%&IR650±10nm	
22	Waterproof	No	
23	Weight	13.7g	
24	Iris Operation	Fixed	
25	Zoom Operation	Fixed	
26	Focus Operation	Manual	
27	Operating Temperature	-20° ~+85°	
28	Storage Temperature	-20° ~+85°	

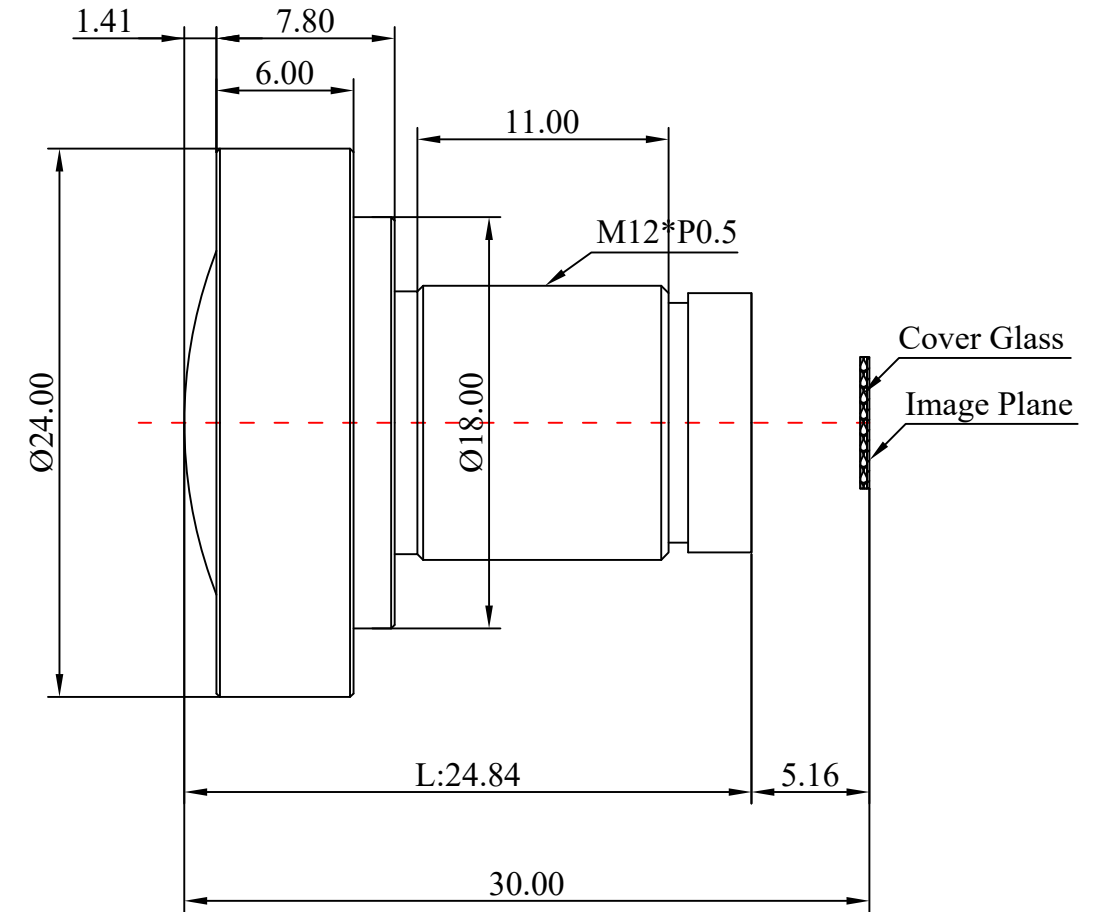

Scale	Remark	Tolerances	Date	Revised		福州创安光电科技有限公司 FUZHOU CHUANGAN OPTICS CO., LTD
4:1	X	±0.2	2020-12-01	CH3658BC Rev1.0		
	X.0	±0.15				
Units	X.00	±0.10	Design	Linda	2020-03-13	
	X.000	±0.001	Checked	Anna	2020-04-09	
mm	Angle	±0.5°	Approval	Sanmu	2020-04-19	

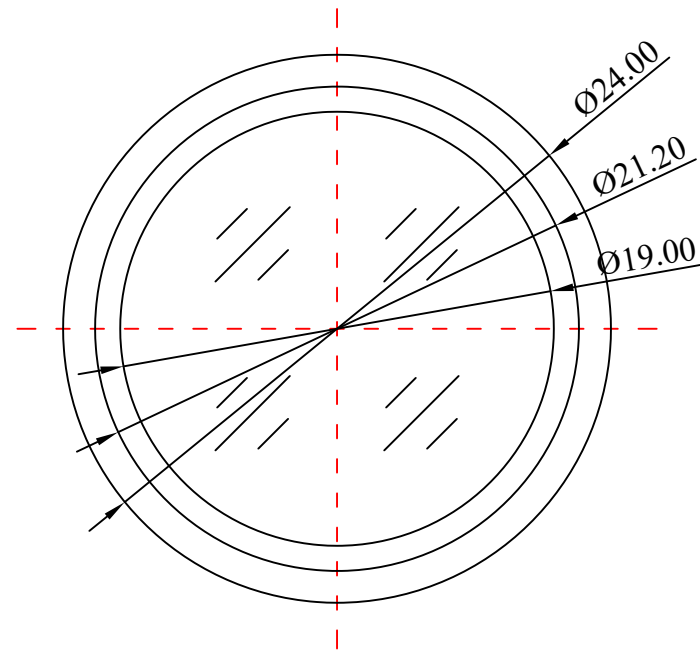