

|    |                  |                    |     |
|----|------------------|--------------------|-----|
| 1  | Type             | Scan Lens          |     |
| 2  | Resolution       | MP                 |     |
| 3  | Image Format     | 1/4"               |     |
| 4  | Image Circle     | φ4.8mm(MAX)        |     |
| 5  | EFL              | 3.55mm             |     |
| 6  | TTL              | 10.58mm            |     |
| 7  | F/NO.            | 5.6                |     |
| 8  | FFL (M)          | 1.39mm             |     |
| 9  | BFL (O)          | 2.16mm             |     |
| 10 | For Sensor       | 1/4"               |     |
| 11 | F.O.V            | Horizontal         | 54° |
| 12 |                  | Vertical           | 43° |
| 13 |                  | Diagonal           | 70° |
| 14 | TV Distortion    | <1%                |     |
| 15 | Relative Ill.    | >50%               |     |
| 16 | Chief Ray Angle  | <10°               |     |
| 17 | M.O.D            | 0.01m~∞            |     |
| 18 | Mount Type       | M12*P0.5           |     |
| 19 | Dimension Figure | φ14.0*L9.63mm      |     |
| 20 | Lens Structure   | 4E+IR              |     |
| 21 | IR-Filter        | T=50%&IR650nm±10nm |     |

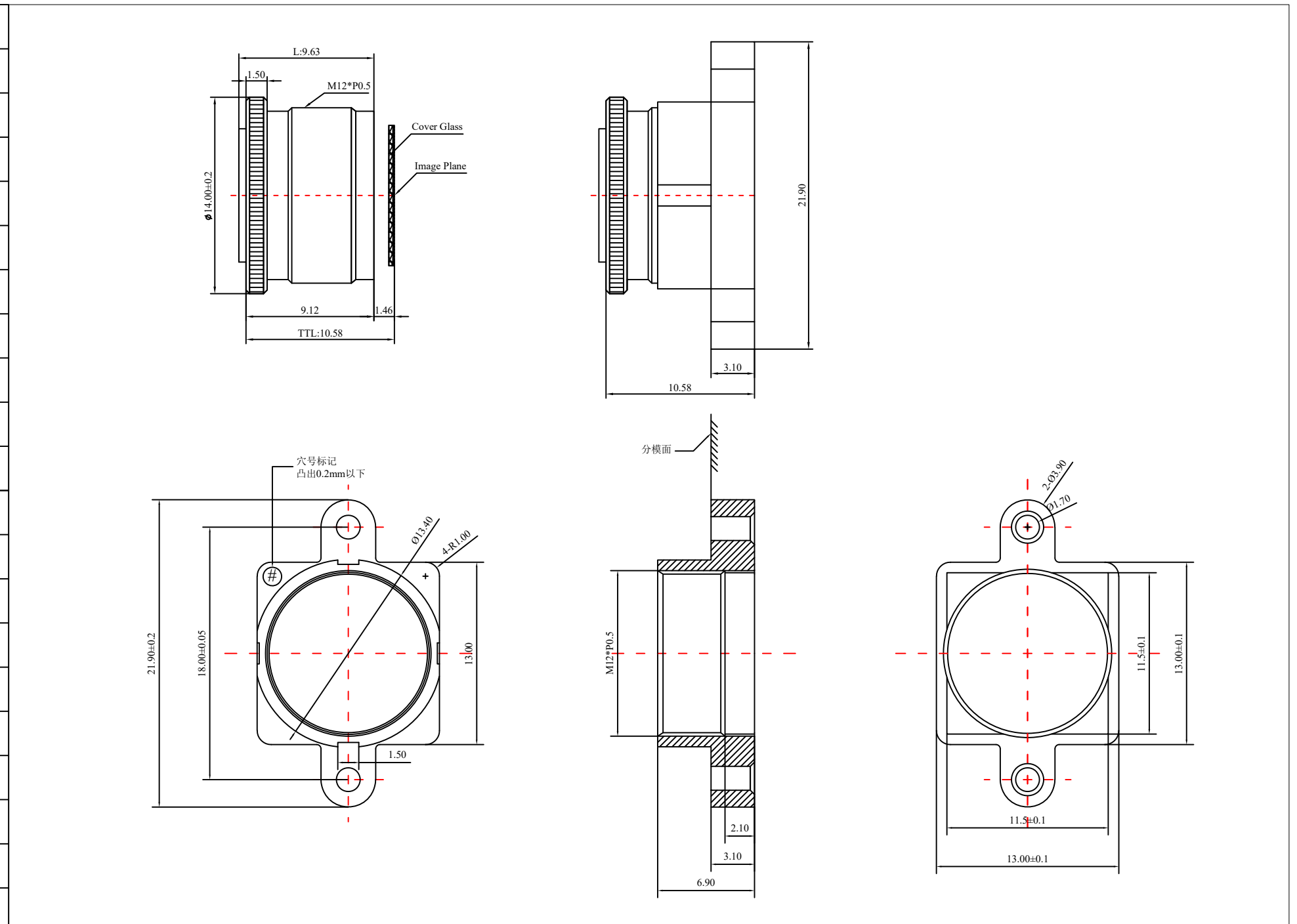
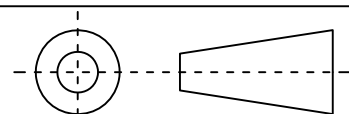

|    |                       |            |       |        |            |          |            |                 |  |
|----|-----------------------|------------|-------|--------|------------|----------|------------|-----------------|--|
| 22 | Weight                | 0.9g       | Scale | Remark | Tolerances | Date     | Revised    |                 | 福州创安光电科技有限公司<br>FUZHOU CHUANGAN OPTICS CO., LTD  |
| 23 | Iris Operation        | Fixed      |       | 4: 1   | X          | ± 0.2    | 2019-10-11 | CH1950CA Rev1.0 |  |
| 24 | Zoom Operation        | Fixed      | X.0   |        | ± 0.15     |          |            |                 |  |
| 25 | Focus Operation       | Manual     | Units | X.00   | ± 0.10     | Design   | Linda      | 2016-08-07      | <br>3D Angle Projection |
| 26 | Operating Temperature | -20° ~+85° |       | X.000  | ± 0.001    | Checked  | Anna       | 2016-10-08      |  |
| 27 | Storage Temperature   | -20° ~+85° | mm    | Angle  | ± 0.5°     | Approval | Sanmu      | 2016-10-13      |  |