

1	Type	Pinhole Lens	
2	Resolution	MP	
3	Image Format	1/2.7"	
4	Image Circle	φ6.8mm(MAX)	
5	EFL	2.8mm	
6	TTL	13.11mm	
7	F/NO.	2.5	
8	FFL (M)	2.44mm	
9	BFL (O)	2.86mm	
10	For Sensor	OV2710	OV4689
11	F.O.V	Horizontal	110°
12		Vertical	56.6°
13		Diagonal	133.6°
14	TV Distortion	<-19.5%	
15	Relative Ill.	>46%	
16	Chief Ray Angle	<13.5°	
17	M.O.D	0.1m~∞	
18	Mount Type	M12*P0.5	
19	Dimension Figure	M12.0*L10.67mm	
20	Lens Structure	3G+2P	
21	IR-Filter	T=50%&IR650±10nm	
22	Weight	3.0g	
23	Iris Operation	Fixed	
24	Zoom Operation	Fixed	
25	Focus Operation	Manual	
26	Operating Temperature	-20° ~+85°	
27	Storage Temperature	-20° ~+85°	

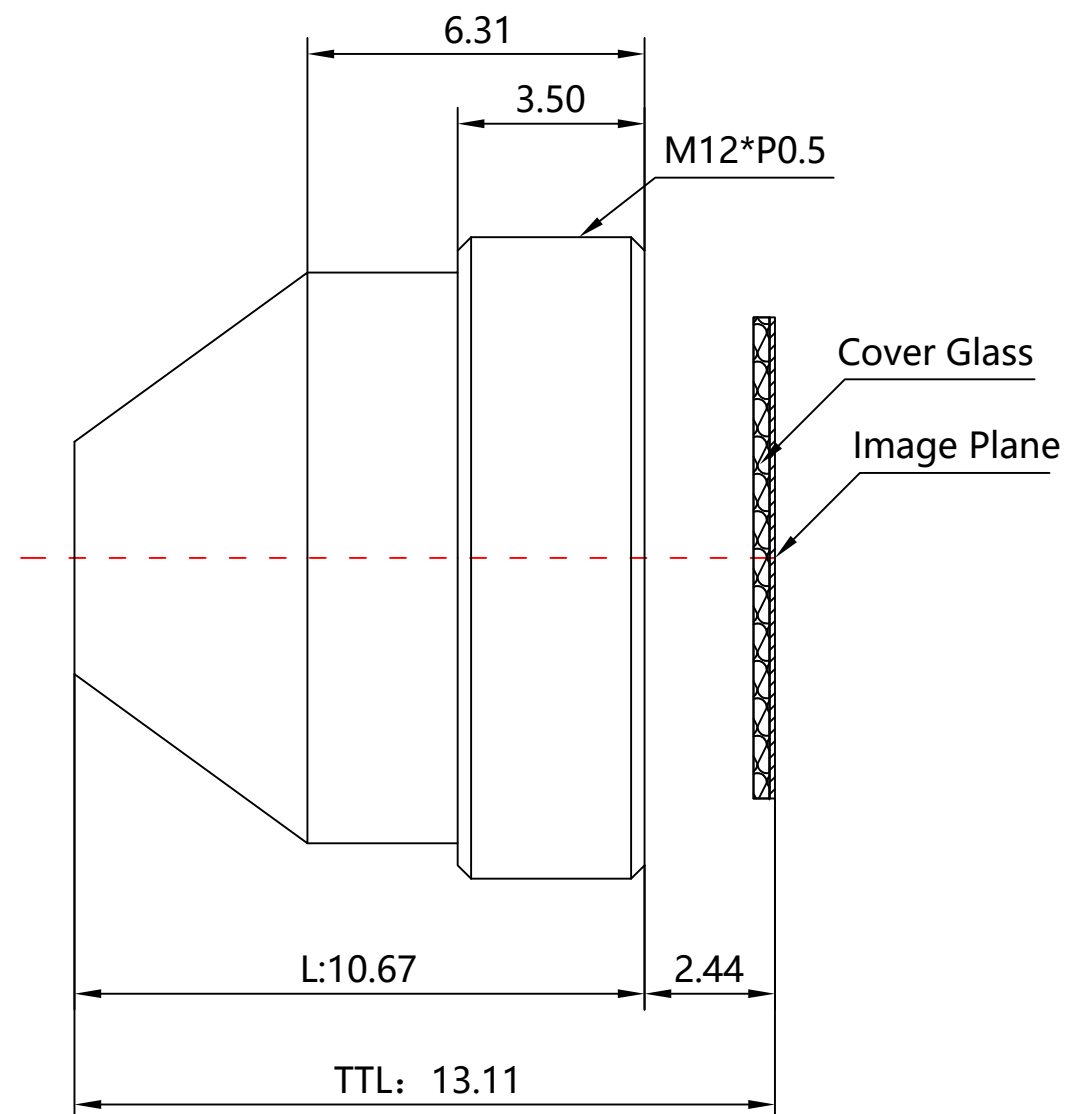

Scale	Remark	Tolerances	Date	Revised		福州创安光电科技有限公司 FUZHOU CHUANGAN OPTICS CO., LTD
4: 1	X	± 0.2	2019-06-28	CH1919A Rev1.0		
	X.0	± 0.15				
Units	X.00	± 0.10	Design	Linda	2019-03-14	
	X.000	± 0.001	Checked	Anna	2019-04-26	
mm	Angle	± 0.5°	Approval	Sanmu	2019-06-28	

